

# Victoria Square

## Retail/Office Space Available



1720 & 1780 S. Woodland Blvd.,  
DeLand, FL 32720

### Property Details:

Total Space Available	4,880 SF
Rental Rate	TBD
Min. Divisible	1,880 SF
Max. Contiguous	3,000 SF
Property Type	Retail
Year Built	1990
Traffic Count	59,530 AADT
Zoning Description	PD (Planned Development)

### Spaces:

Suite	Space Available	Min Divisible	Max Contiguous	Price	Date Available	Description
1720	3,000 SF	3,000 SF	3,000 SF	TBD	120 Days	Retail/Office
1780	1,880 SF	1,880 SF	1,880 SF	TBD	120 Days	Retail/Office

### Location Description:

- Nearby Tenants include Wawa, Gator's Dockside Restaurant, UPS Store, Pinch A Penny, & Future Home to State of the Art 18,000 SF Pickleball Wellness Center
- Busy corner of 15A (Spring Garden) & Hwy 17-92
- 2022 estimated average household income: \$84,076
- 2022 estimated population within 5 miles: 80,711
- 2022 estimated households within 5 miles: 31,288



Commercial Sales & Leasing | Property Management | Project Development | Acquisitions & Dispositions | Construction Services

Southeastern Realty Group, Inc. - 933 Lee Road Suite 400 - Orlando, FL 32810 - t: 407-629-5595 - f: 407-645-2035



# Floor Plan:

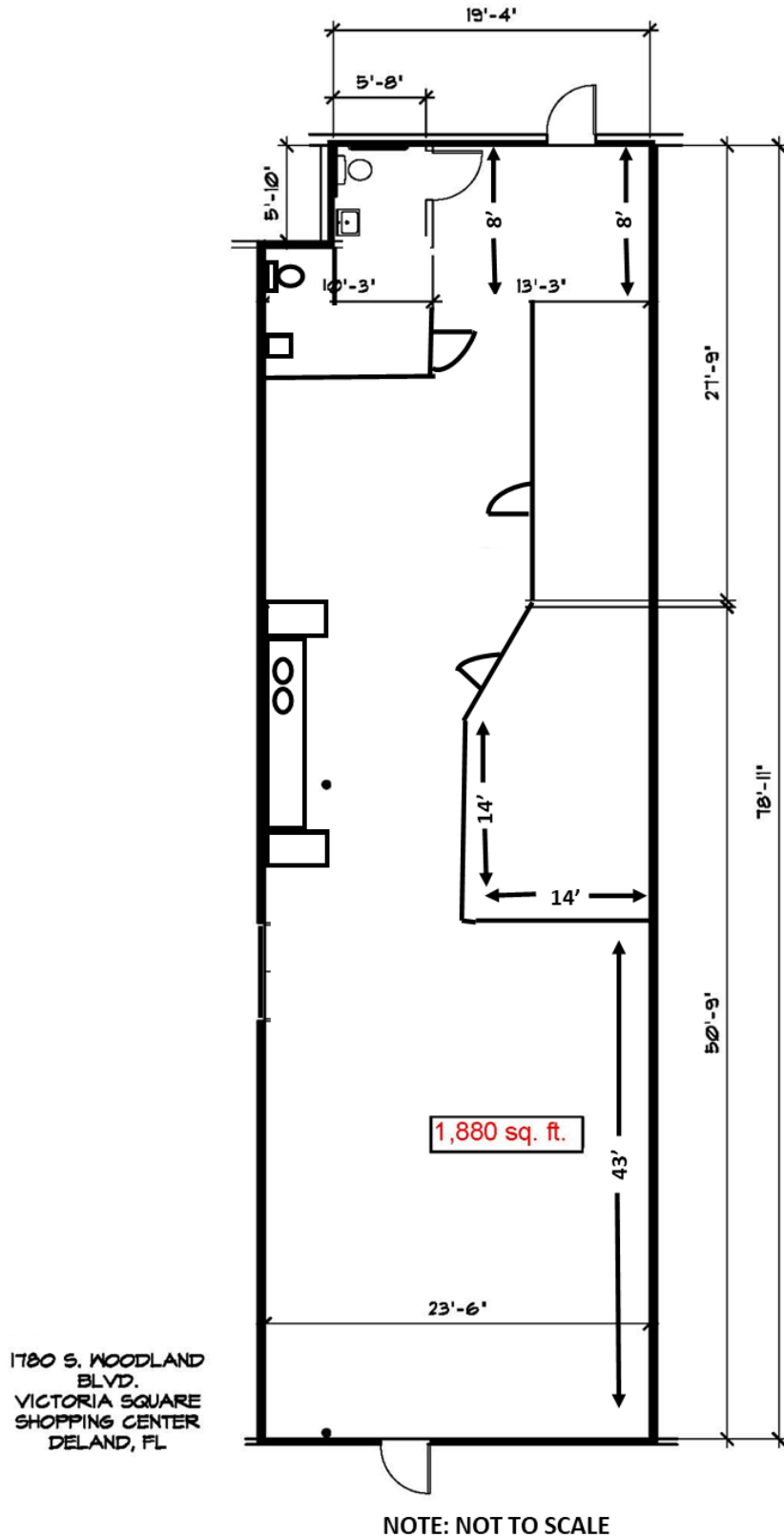

Southeastern Realty Group  
933 Lee Road, Suite 400, Orlando, Florida 32810  
407-629-5595 phone, 407-645-2035 fax  
Visit our website at [www.southeasternrealty.com](http://www.southeasternrealty.com)