

Victoria Square

Retail Space for Lease

1750 & 1784 S. Woodland Blvd.,
DeLand, FL 32720

Property Details:

| | |
|-----------------------|-------------|
| Total Space Available | 18,306 SF |
| Rental Rate | TBD |
| Min. Divisible | 1,200 SF |
| Max. Contiguous | 17,106 SF |
| Property Type | Retail |
| Year Built | 1990 |
| Traffic Count | 59,530 AADT |
| Zoning Description | C-3 |



Spaces:

| Suite | Space Available | Min Divisible | Max Contiguous | Price | Date Available | Description |
|-------|-----------------|---------------|----------------|-------|----------------|-------------|
| 1750 | 17,106 SF | 17,106 SF | 17,106 SF | TBD | Now | Retail |
| 1784 | 1,200 SF | 1,200 SF | 1,200 SF | TBD | Now | Retail |

Location Description:

- Abundance of parking and great visibility
- Located in DeLand's expanding commercial corridor
- Busy corner of 15A (Spring Garden) & Hwy 17-92
- 2015 estimated average household income \$53,919
- 2015 Estimated population within 3 miles: 42,687
- Daytime population within 3 miles: 42,402



Commercial Sales & Leasing | Property Management | Project Development | Acquisitions & Dispositions | Construction Services

Southeastern Realty Group, Inc. - 933 Lee Road Suite 400 - Orlando, FL 32810 - t: 407-629-5595 - f: 407-645-2035

Floor Plans:

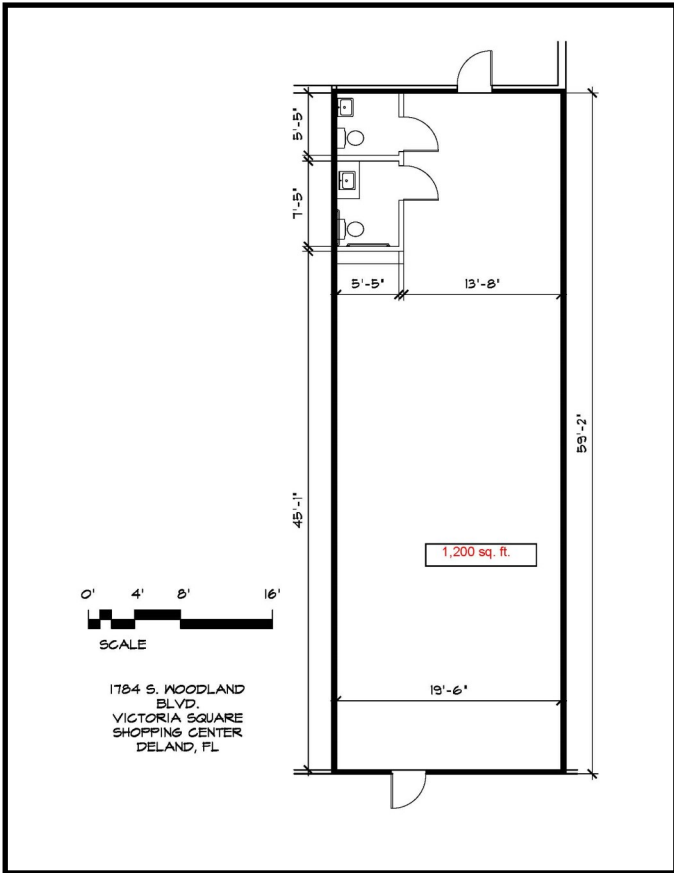

Suite 1784 - 1,200 SF

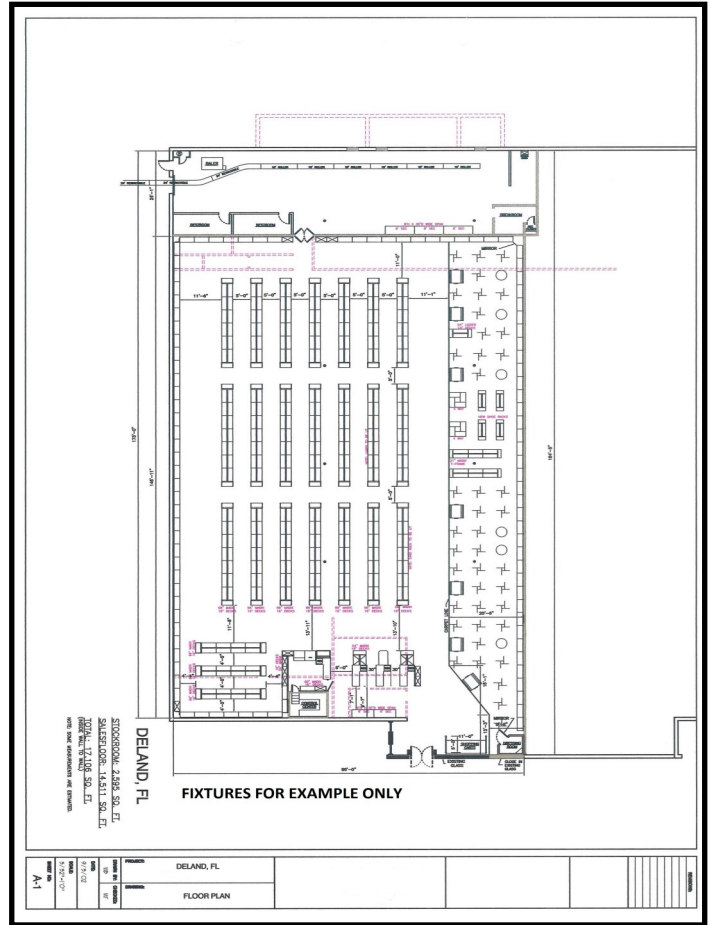

Suite 1750 - 17,106 SF

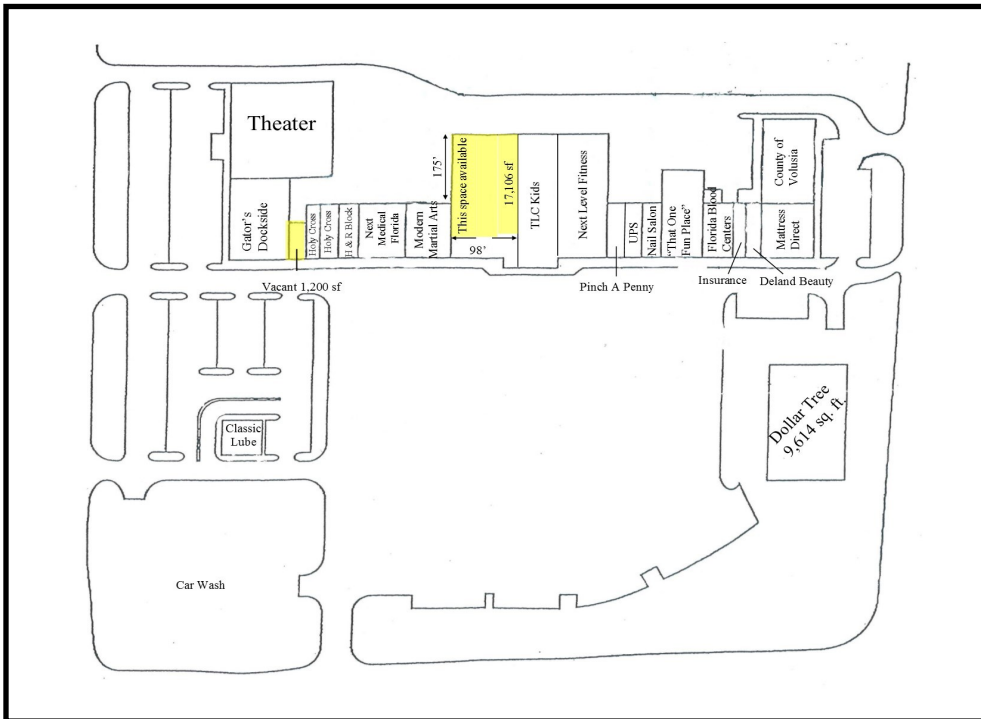

Available Space

Southeastern Realty Group
933 Lee Road, Suite 400, Orlando, Florida 32810
407-629-5595 phone, 407-645-2035 fax
Visit our website at www.southeasternrealty.com