

Park Center

Industrial Office/ Warehouse Space for Lease



**Parkway Commerce Blvd.,
Orlando, Florida 32808**

Property Details:

| | |
|-----------------------|------------|
| Total Space Available | 61,600 SF |
| Min. Divisible | 1,600 SF |
| Max. Contiguous | 60,000 SF |
| Property Type | Industrial |
| Property Sub-type | Flex Space |
| Building Size | 124,800 SF |
| Zoning Description | I-P/W |

Spaces:

| Suite/ Bldg | Space Available | Min Divisible | Max Contiguous | Date Available | Rate/Lease Type |
|-------------|-----------------|---------------|----------------|----------------|-----------------|
| 4724 | 1,600 SF | 1,600 SF | 1,600 SF | Jan. 1, 2019 | \$9.25/ PSF |
| 4609 - 4623 | 10,800 SF | 10,800 SF | 60,000 SF | Now | Negotiable/ MG |
| 4509 - 4605 | 22,800 SF | 22,800 SF | 60,000 SF | Now | Negotiable/ MG |
| 4501 - 4518 | 26,400 SF | 26,400 SF | 60,000 SF | Now | Negotiable/ MG |

Location Description:

- Office/ Warehouse/ Distribution/ Manufacturing
- Serviced by Tri-County Bus Line
- Ground level service doors
- Centrally located, convenient access to interstate and major highways

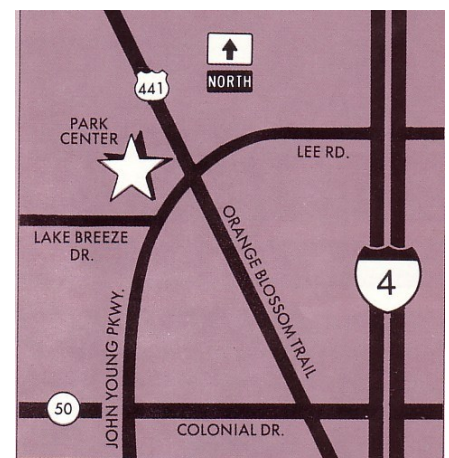

Commercial Sales & Leasing | Property Management | Project Development | Acquisitions & Dispositions | Construction Services

Southeastern Realty Group, Inc. - 933 Lee Road Suite 400 - Orlando, FL 32810 - t: 407-629-5595 - f: 407-645-2035



Park Center 606 Building
 4501- 4643 Parkway Commerce Blvd, Orlando, FL 32808

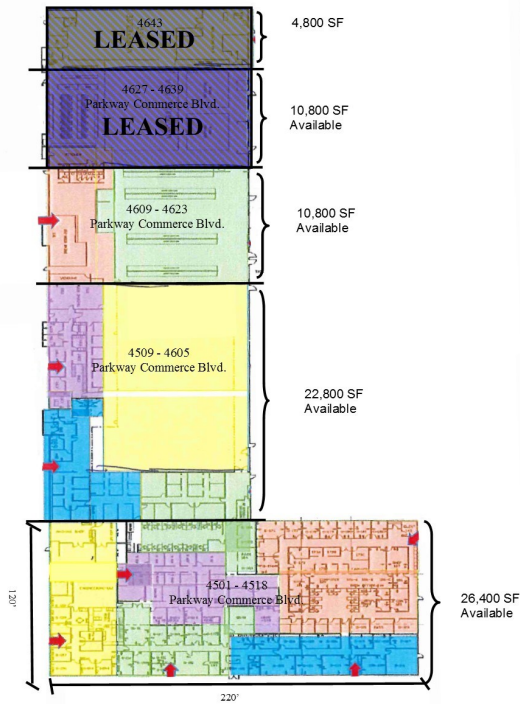

Total Building
 75,600 SQ. FT.

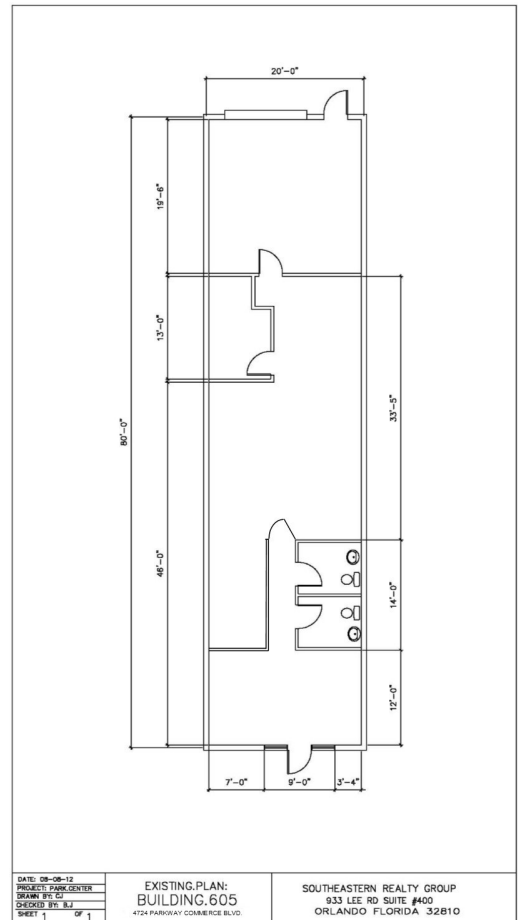

Southeastern Realty Group
 933 Lee Road, Suite 400, Orlando, Florida 32810
 407-629-5595 phone, 407-645-2035 fax
 Visit our website at www.southeasternrealty.com