

International Promenade  
4951 W. Irlo Bronson Memorial Hwy.  
Kissimmee, FL 34746

**1208 - 8114 sq. ft.**  
**Available for Lease**

(corner of S.R. 535 and US Hwy 192)



**Zoned - PD**

## Features:

- Prime retail location in Florida's tourist market and Disney corridor
- Mix of tourist and neighborhood tenants
- **8,114 sq. ft . restaurant space**
- 32,000 hotel rooms in immediate vicinity
- 2009 estimated average household income within 3 miles: \$59,341
- 2009 estimated population within 3 miles: 29,571
- 2009 estimated population within 5 miles: 99,617
- Daily traffic count: 42,000



933 Lee Road, Suite 400, Orlando, FL 32810  
407-629-5595 phone, 407-645-2035 fax  
Visit our website at [southeasternrealty.com](http://southeasternrealty.com)

**Trish DeBell**  
**407-629-5595 x 236**  
**tdebell@southeasternrealty.com**

Kyngs Heath Road

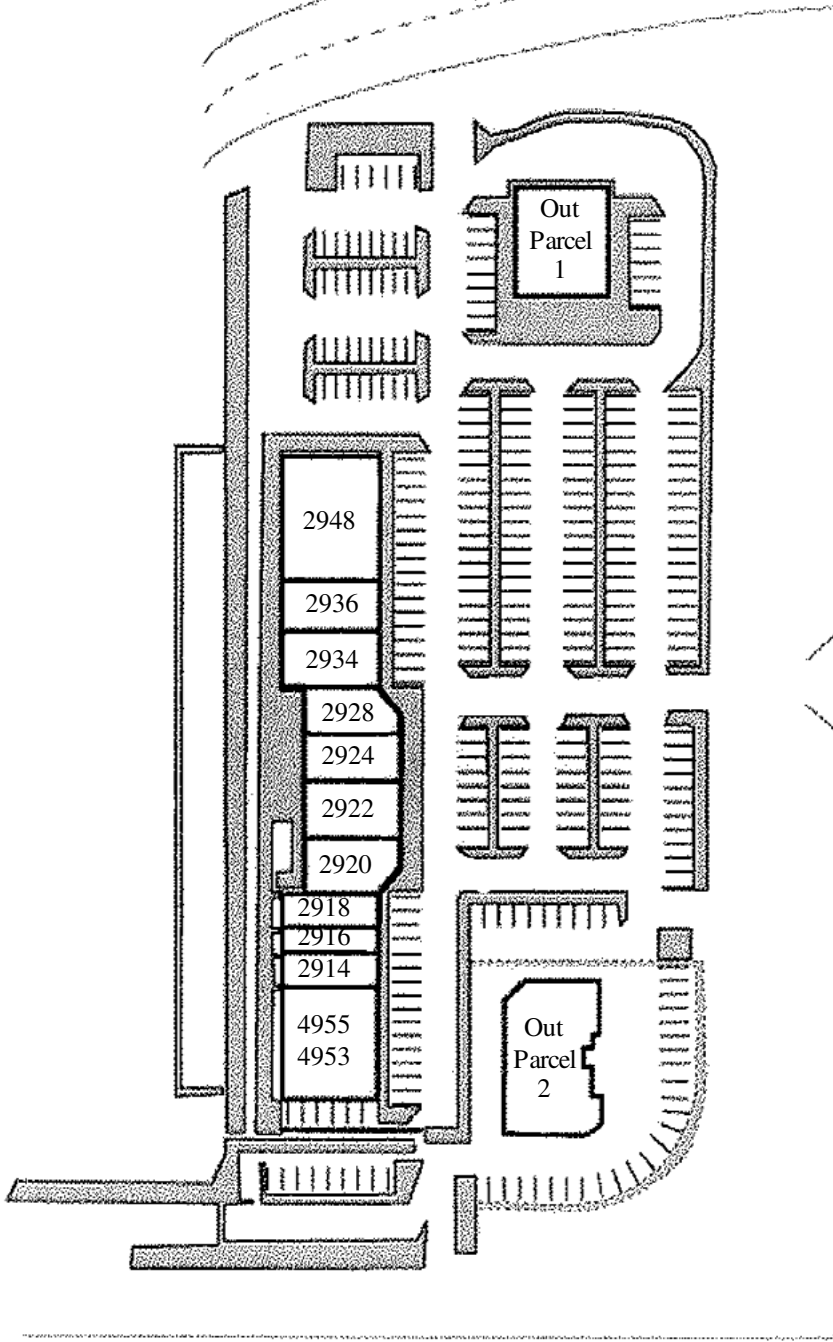

State Road 535

US Highway 192