

THE DISTRICT - UNIVERSAL BLVD.
9650 - 9702 Universal Blvd
Orlando, FL 32819

1,185 - 15,106 sq. ft.
First Floor Retail
For Lease



**Apartment Leasing
commenced October
2009**

**Over 350 apartments
now leased**

**March 2010 -
Walgreens opened**

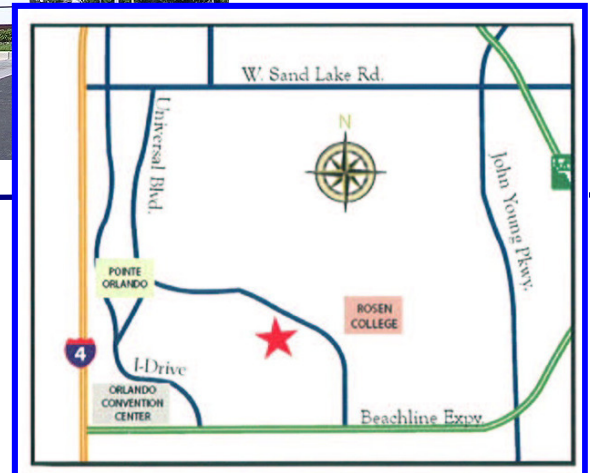

Features:

- 425 on site primary residential units
- On entrance drive to new, 994 unit extend stay/resort residential community
- University of Central Florida's Rosen School of Hospitality: 2,200 students & 400 dormitory rooms .74 from site
- Within walking distance to Orange County Convention Center, retail and entertainment space, shopping centers and over 8,000 combined primary residential and major hotel units.
- Average daily attendance at Orange County Convention Center within walking distance: 3,600
- Attendant employment - over 10,000 within 1 mile and over 77,000 within 3 miles.
- 2009 estimated average income within 3 miles: \$84,124



933 Lee Road, Suite 400, Orlando, FL 32810
407-629-5595 phone, 407-645-2035 fax
Visit our website at www.southeasternrealty.com

Gil Daniel
407-629-5595 x 233
407-443-9130 Cell
gil1@southeasternrealty.com

Southeastern Realty Group

The information contained herein is from sources deemed reliable, but no warranty or representation is made as to the accuracy thereof and no liability may be imposed.

FLOOR PLAN

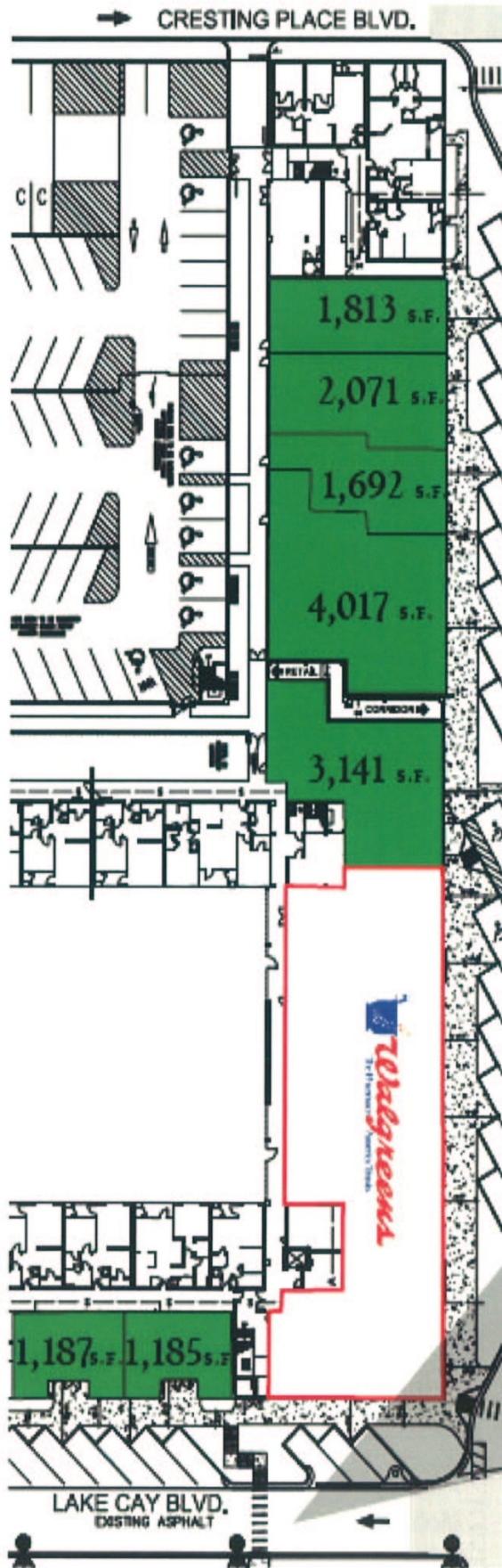

VENUES IN WALKING DISTANCE TO THE DISTRICT - UNIVERSAL BLVD INCLUDE:

- 7.25 million s.f. of convention space, and 1.5 million s.f. of retail and entertainment space
- The Village of Imagine; a Westin condo/hotel resort
- Hilton Orlando
- Marriott
- Hyatt
- The Rosen shingle Creek Resort and Convention Center
- The Peabody Orlando
- Rosen Plaza & Rosen Centre on International Drive
- Embassy Suites - International Drive South
- International Plaza Resort & Spa
- Hyatt Place Orlando Convention Center
- Pointe Orlando
- The Orange County Convention Center
- Lake Cay Commons Shopping Center (Publix anchored)

Entrance to 1,419 new Residential & Resort Units