

**Adanson Business Center  
5125 – 5135 Adanson St.  
Orlando, FL 32804**

**Up to 9,504 sq. ft.  
Available  
For Lease**



**Features:**

- 1,400 sq. ft., 1,758 sq. ft. and 9,504 sq. ft. available
- Corner units, ground level access
- Ample parking
- Zoned C-2
- Easy access to I-4 and US Highway 441
- Conveniently located near Maitland, downtown Winter Park and downtown Orlando.



933 Lee Road, Suite 400, Orlando, FL 32810

407-629-5595 phone, 407-645-2035 fax

Please visit our website at [southeasternrealty.com](http://southeasternrealty.com)

**Bryan Johnson**

**407-629-5595 x 226**

**[bjohn@southeasternrealty.com](mailto:bjohn@southeasternrealty.com)**

Southeastern Realty Group, Inc.

The information contained herein is from sources deemed reliable, but no warranty or representation is made as to the accuracy thereof and no liability may be imposed

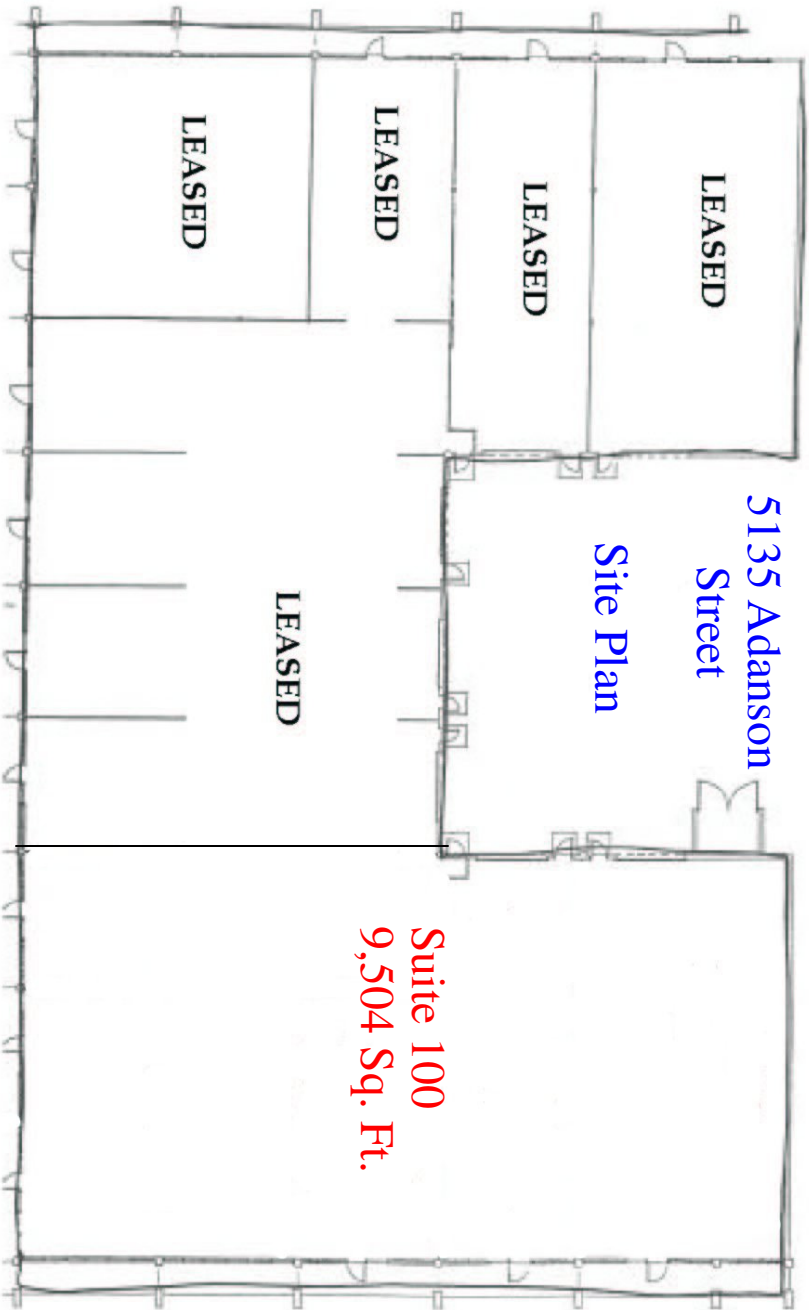

5135 Adanson Street

Site Plan

Suite 100  
9,504 Sq. Ft.

LEASED

LEASED

LEASED

LEASED

LEASED

LEASED