

International Promenade
4951 W. Irlo Bronson Memorial Hwy.
Kissimmee, FL 34746
(corner of S.R. 535 and US Hwy 192)

1208 - 8114 sq. ft.
Available for Lease

Zoned - PD



\$14.00 per sq. ft. NNN
\$ 5.00 Current CAM

Features:

- Prime retail location in Florida's tourist market and Disney corridor
- Mix of tourist and neighborhood tenants
- **8,114 sq. ft . restaurant space**
- 32,000 hotel rooms in immediate vicinity
- 2009 estimated average household income within 3 miles: \$59,341
- 2009 estimated population within 3 miles: 29,571
- 2009 estimated population within 5 miles: 99,617
- Daily traffic count: 42,000



933 Lee Road, Suite 400, Orlando, FL 32810
407-629-5595 phone, 407-645-2035 fax
Visit our website at southeasternrealty.com

Trish DeBell
407-629-5595 x 236
tdebell@southeasternrealty.com

Kyngs Heath Road

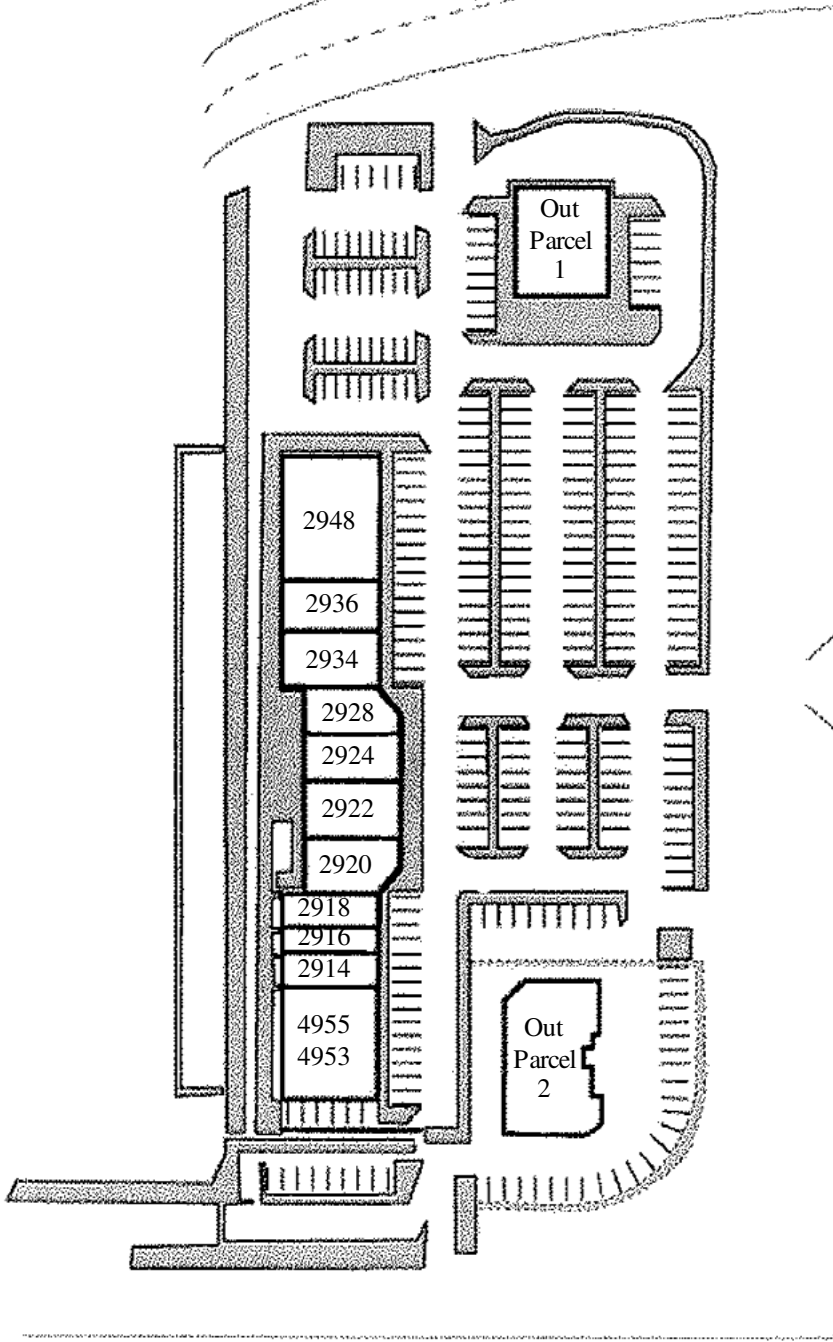

State Road 535

US Highway 192